

airox

*Smart Harmony Of
air & water*

BIOFILM CARRIER MEDIA

TECHNICAL

DATA

SHEET

W A B E 1 / 2 / 3

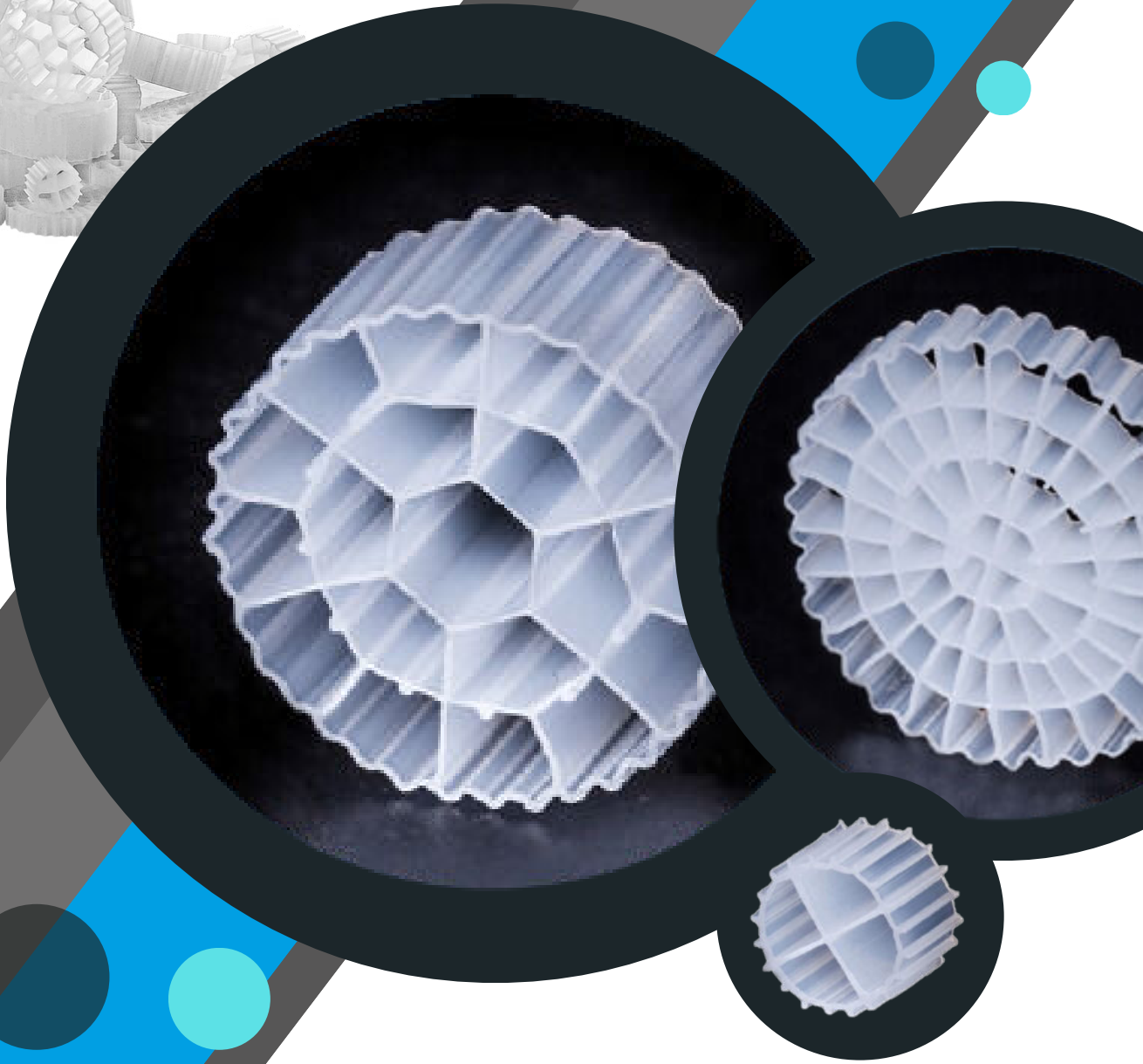
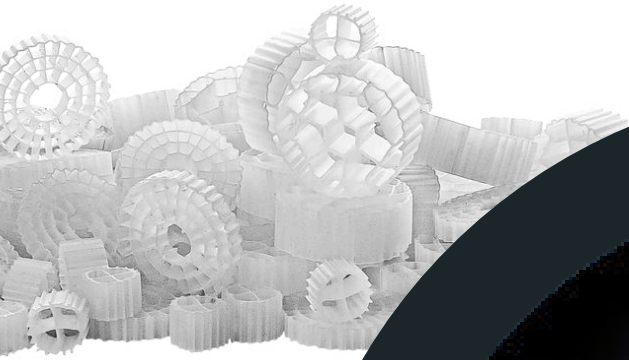

www.airox.com.tr



MOVING BED BIOFILM REACTOR TECHNICAL DATA SHEET

DIMENSIONS

	WABE-1	WABE-2	WABE-3
Diameter x Height (mm)	11 x 7	25 x 10	25 x 4
Specific Surface Area (m ² /m ³)	>800	>500	>1200
Specific Weight (gr/cm ³)	0,96	0,96	0,96
Weight (kg/m ³)	150	105	120
Durability (year)	10	10	10
Material	HDPE	HDPE	HDPE



WABE-1

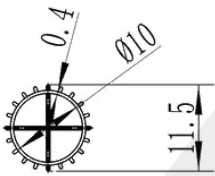

WABE-2

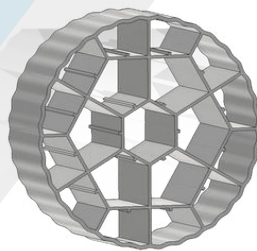
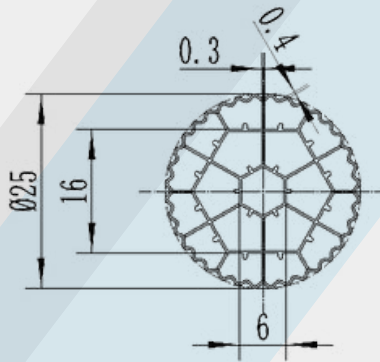

WABE-3

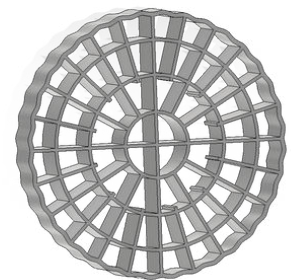
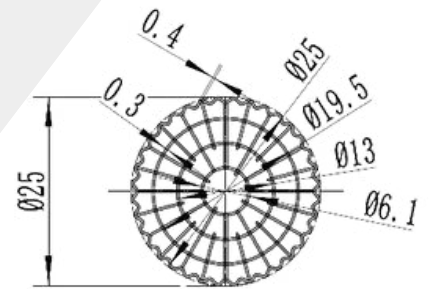

airox

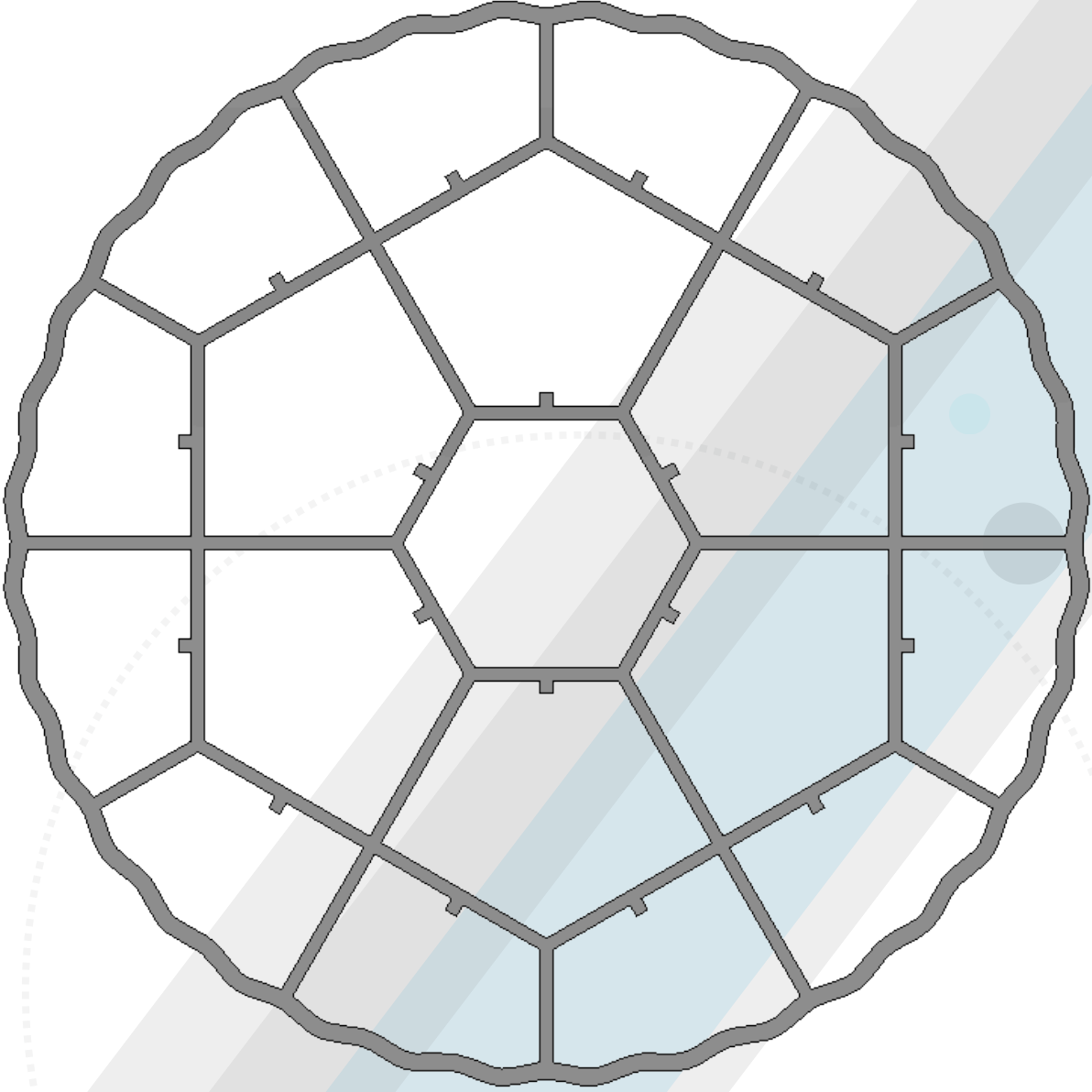

GİF PLASTİK SAN. TİC. LTD. STİ.
KAYAPA MAH. ,NERGİZ(530) CAD. ,NO:7,
NİLÜFER/BURSA 16130
TEL : +90 224 443 77 84-85
MOBILE : +90 541 881 00 40
FAX : +90 224 243 34 24
email : info@airox.com.tr



www.airox.com.tr

airox